

① First Floor Plan  
1/16" = 1'-0"

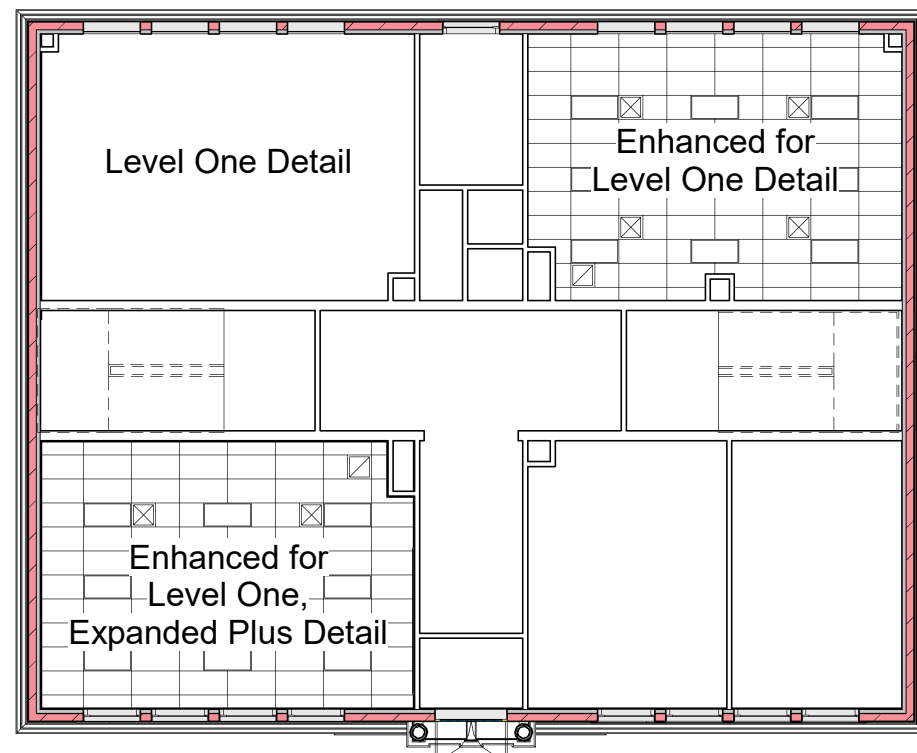

② First Floor Reflected Ceiling Plan  
1/16" = 1'-0"

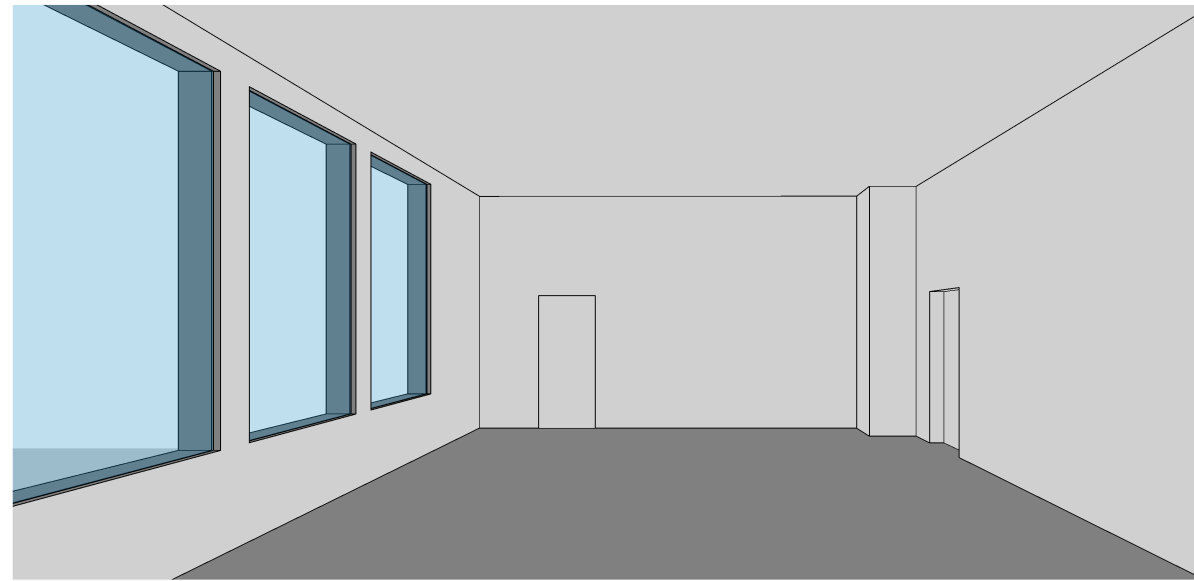

③ Level One Detail

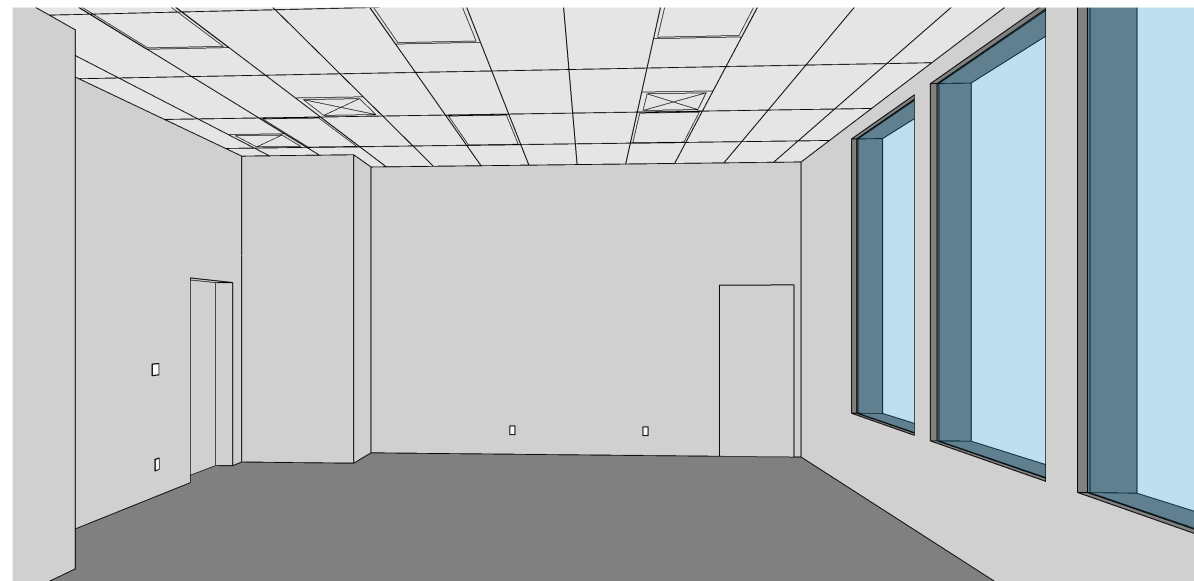

④ Enhanced for Level One Detail

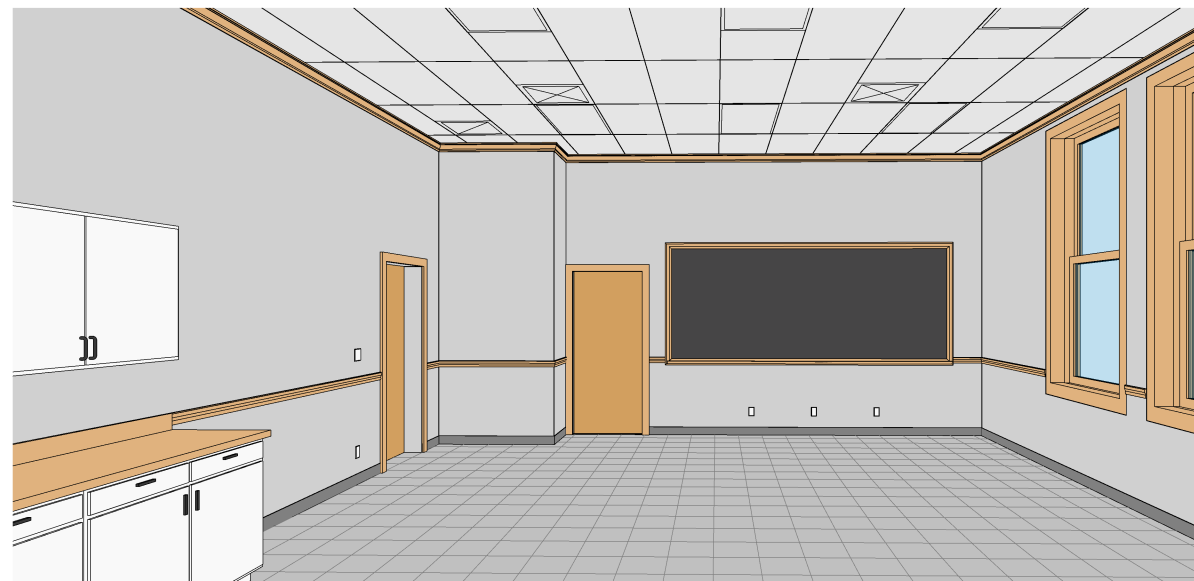

⑤ Enhanced for Level One, Expanded Plus Detail

**Level One Detail**

3-D ~ BIM Architectural Floor Model [walls modeled to field-measured height, windows, doors, visible columns, stair treads, accurate floor-to-floor heights] including kitchen & bathroom fixtures & cabinetry [footprints] and major MEP's [footprints] and ceiling heights/planes. This level includes a gross massing of the exterior with fenestrations accurately depicted with respect to sizes and locations, however, no exterior features will be captured.

**Enhanced for Level One Detail**

Enhances a Level One model with 3-D ~ BIM representations of all visible & accessible mechanical, electrical, plumbing & life safety elements which penetrate finished surfaces [walls, ceilings & floors]. Includes Reflected Ceiling Plan elements.

**Enhanced for Level One, Expanded Plus Detail**

Expands on a Level One Model with 3-D ~ BIM representations of all visible & accessible architectural interior elevation features [baseboards, crown moldings, chair rails, fixed furnishings, built-ins, cabinetry, etc.], as well as adding finish materials [wall, ceiling & floor finishes].